

LADDER BRACING ASSEMBLY GUIDE

Step 1 - Secure Shelves

To prevent shelf slats from moving independently, screw the metal tie strap into the bottom of the shelf set with all 4 boards pushed together. Use the ½" long lathe screws (A) provided.

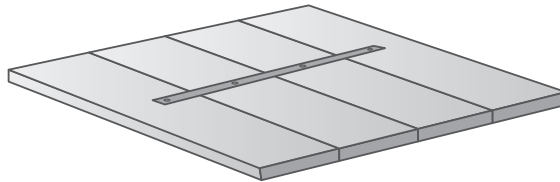

Step 2 - Corner Bracing

To improve lateral stability, screw metal corner braces into the upright rails and the topmost rungs on both ladders. Use the ½" long #10 screws (B) provided.

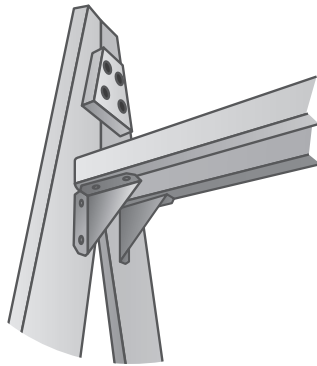

Step 3 - Wood Bracing

To improve lateral stability, screw the 1x4 24-½" long pine board underneath the lower shelf, behind the rung, using the 1-½" long lathe screws (C) provided. Predrilling holes is recommended.

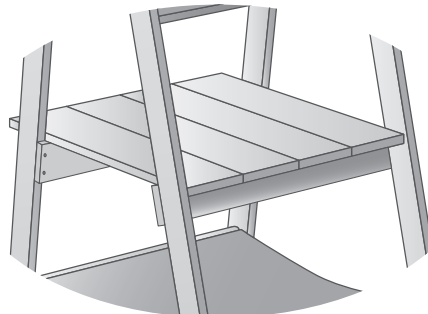

Parts

A) Lathe Screw (x16) - ½" long



B) Brace Screw (x16) - #10 x ½" long



C) Lathe Screw (x16) - 1 - ½" long

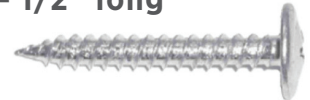

D) Tie Strap (x4)



E) Corner Brace (x4)



F) Wood Brace (x4)



G) Rug Clamps (x10)



H) Art Hooks (x10)

