

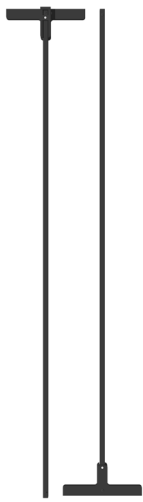





PARTS LIST

<p>①</p>  <p>Legs 2 pc</p>	<p>②</p>  <p>Graphic* 1 pc</p>	<p>③</p>  <p>Dowel with Threaded Endcap* 1 pc</p>
		<p>④</p>  <p>Black-Capped Dowel* 1 pc</p>
		<p>⑤</p>  <p>Black Bar with Threaded Ends 1 pc</p>
		<p>⑥</p>  <p>Bolts 4 pc</p> <p>⑦</p>  <p>Allen Wrench 1 pc</p> <p>*The graphic² may arrive with both dowels already inserted in the pole pockets: The threaded endcap dowel³ in the top pocket and the black-capped dowel⁴ in the bottom pocket. If the dowels are not already inserted into the graphic, do this before proceeding to step 1.</p>

ASSEMBLY INSTRUCTIONS

STEP 1

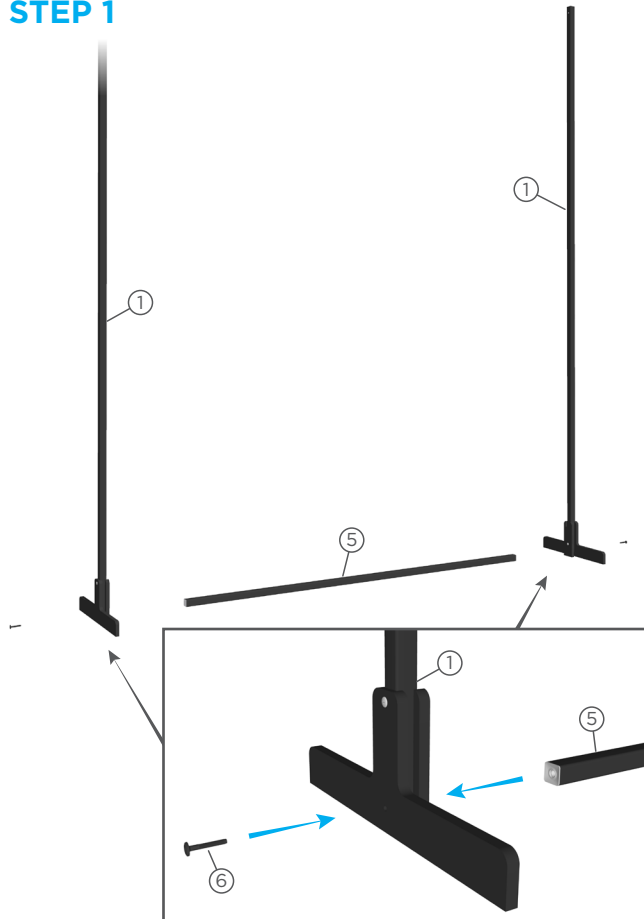

Using the allen wrench⁷ and two of the bolts⁶, attach the black bar⁵ to the base of legs¹.

STEP 2

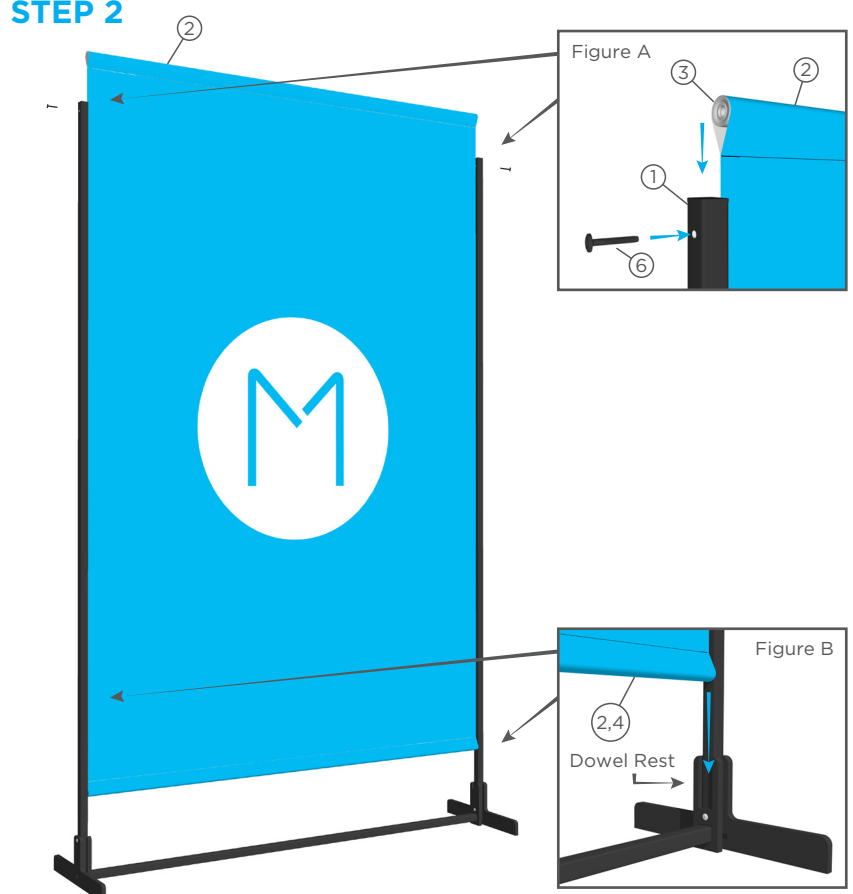

Figure A: Install the graphic² by first attaching the threaded dowel³ in the graphic's top pole pocket to each leg¹ using the two remaining bolts⁶ and the allen wrench⁷.
Figure B: Then, insert the bottom of the graphic (includes black-capped dowel⁴) into the dowel rests. Your EZ Banner Stand is now fully assembled.