









PARTS LIST

①  L-Connector Bar 2 pc	②  L-Connector Bar w/Velcro End 2 pc	③  Middle Bar 4 pc	④  Graphic 1 pc
⑤  Short Bar with Velcro 4 pc	⑥  Long Bar 4 pc		
⑦  80ct Bag of Lights* 2 pc	⑧  Long Bar with Threaded Rod 4 pc		

YOU WILL NEED: Ladder(s), hammer, screwdriver

*If the Bella Monument is being ordered with the Lit Bella Insert, these lights will be included with that product.

While assembly is possible with one person, due to the size of the sign, two people is highly recommended and three is preferred for easy assembly and installation.

ASSEMBLY INSTRUCTIONS

These steps show assembly around a structural column. If the Bella Monument is going to be freestanding, being used with the separate Lit Bella Insert, or if you wish the graphic to be unlit, skip Step 1 and follow the remaining steps.

STEP 1



Peel off the adhesive backs of the **lights**⁷ as you attach them to the structural column in a spiral pattern.

STEP 2

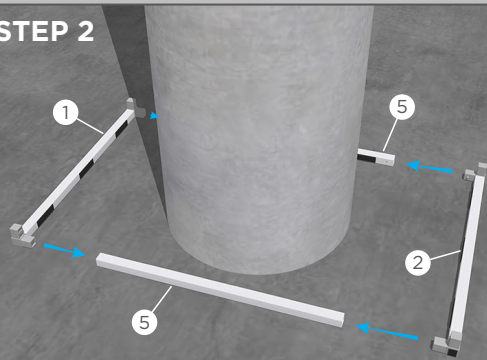

Place two **short bars**⁵ on opposite sides of the column with the velcro facing inward. Next, with the velcro sides again facing inward, insert an **L-connector bar**¹ into the ends of one side of the short bars and an **L-connector bar with velcro**² into the other ends of the short bars to complete the base.

STEP 3

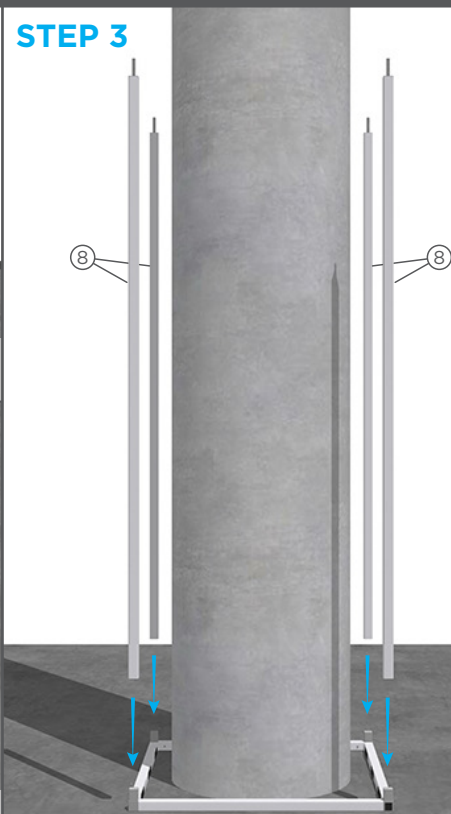

Insert the open end of the four **long bars with threaded rods**⁸ into the base connectors. The threaded rods should be facing upward.

STEP 4

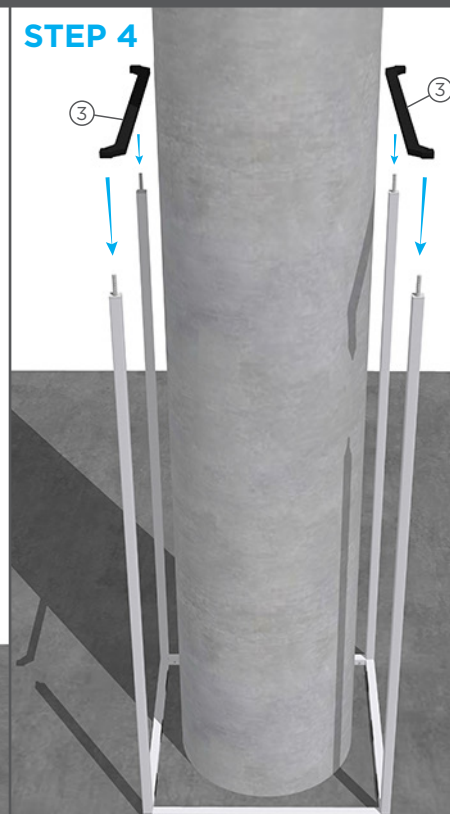

On opposite sides of the column, thread the rods of the long bars through the ends of two **middle bars**³, making sure the bar's curve is facing inward.

ASSEMBLY INSTRUCTIONS (CONTINUED)

STEP 5

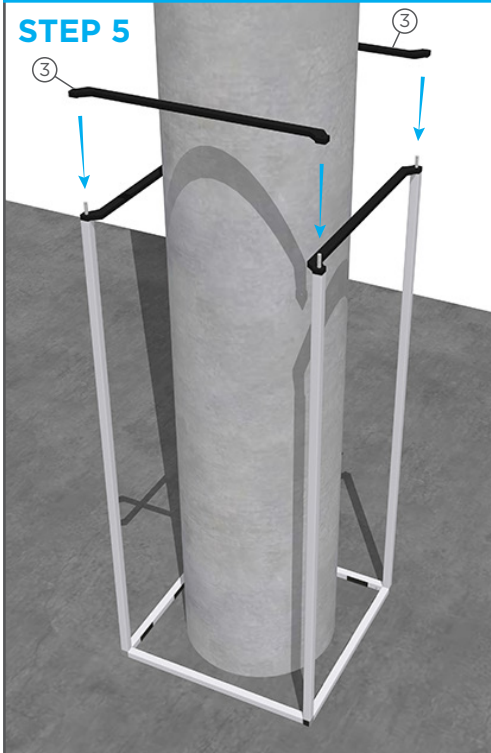

Repeat **step 4** with the remaining two **middle bars**³ to form the middle brace of the Bella Monument.

STEP 6

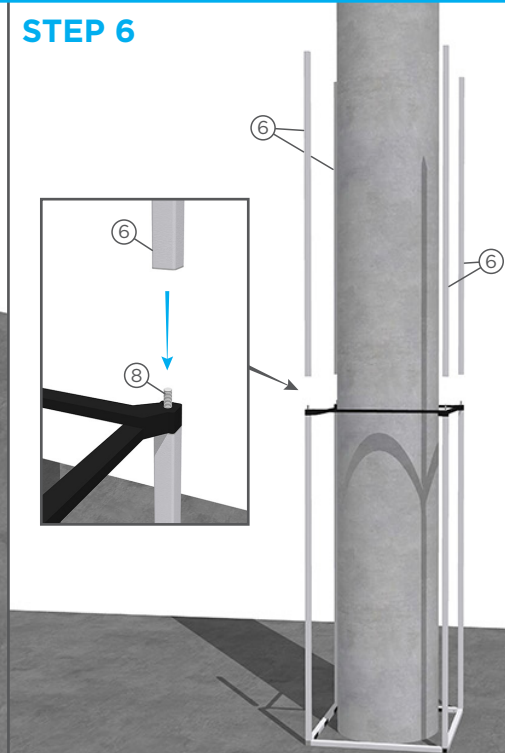

Attach the four **long bars**⁶ by screwing one into each of the **threaded rods**⁸.

STEP 7a

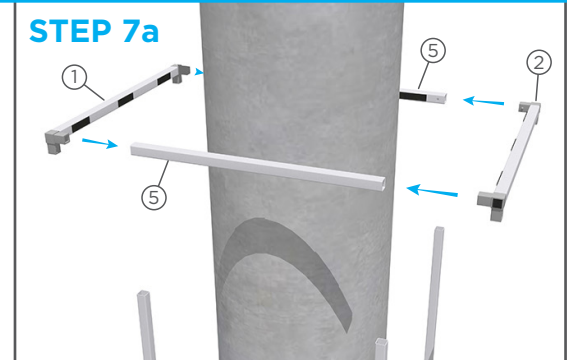

STEP 7b

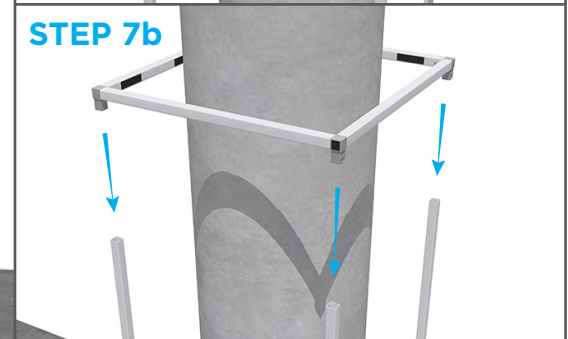

(7a) Repeat the process from **step 2** at the top with the remaining **L-connector bars**^{1,2} and **short bars**⁵. Make sure the exposed connectors are facing down and that the outward velcro face on the **L-connector**² is on the same end and facing the same way as the one on the base. (7b) Insert the assembled top into the top ends of the **long bars**⁶.

STEP 8

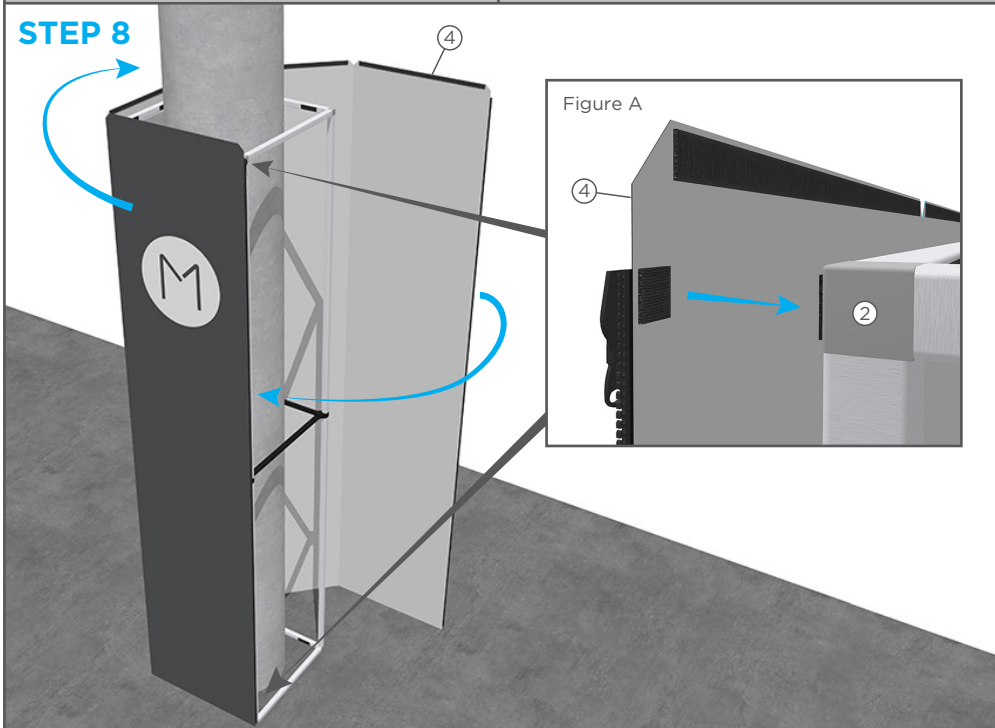

Attach the velcro square on the inside-top and bottom edge of the **graphic**⁴ to the velcro square on the outside of the base and top of the frame (Figure A). This will help keep the graphic in place as you wrap the graphic around the frame.

STEP 9a

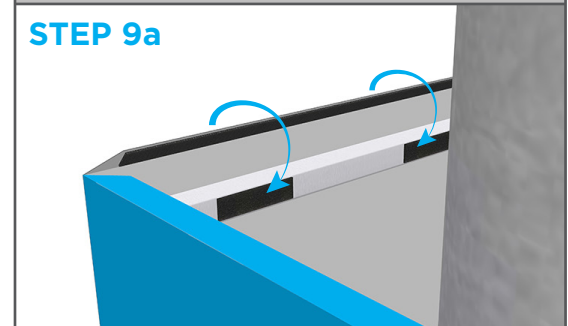

STEP 9b



(9a) Fold the top flaps of the graphic over the top of the frame and attach the velcro from the graphic to the velcro on the inside of the frame. Do the same to attach the bottom flap of the graphic to the base of the frame. (9b) Lastly, zip up the two edges of the graphic to complete the Bella Monument.